

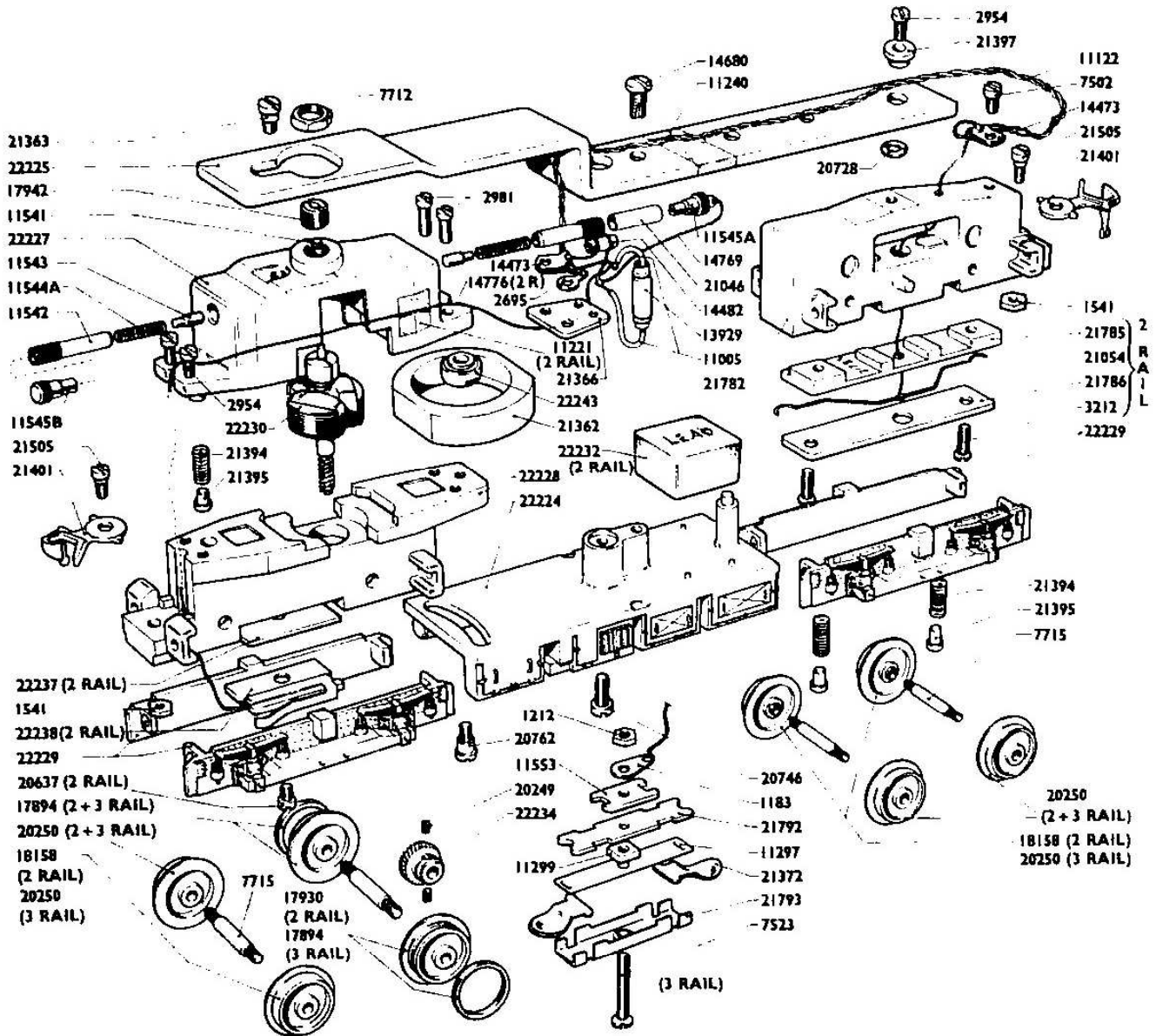

ELECTRIC MOTOR COACH 2 AND 3-RAIL

No. 2250 2-RAIL — No. 3250 3-RAIL



- 1541 Nut
- 2695 Soldering Tag
- 2954 Screw
- 2981 Screw
- 7502 Screw
- 7712 Locking Nut
- 7715 Axle
- 11005 P.V.C. Sleeve
- 11545A Plug (with boss)
- 13929 Choke
- 14473 Clamp for Wire
- 14482 Condenser
- 14769 Connecting Wire
- 21366 Insulating Support
- 11122 Connecting Wire
- 11240 Self Adhesive Tape
- 11541 Ball Bearing
- 11542 Brush Holder
- 11543 Brush
- 11544A Spring
- 11545B Plug
- 14680 Screw
- 17942 Adjustable Bearing Housing Assembly
- 20249 Grub Screw
- 20250 Wheel
- 20251 Wheel (with tyre groove)
- 20252 Tyre
- 20728 Washer
- 20746 Screw
- 20762 Screw
- 21046 Insulating Sleeve

Suppression Assembly
Job No. 18426

Wheel (with tyre) Assembly
Job No. 17894

- 21362 Ring Magnet
- 21363 Screw
- 21394 Spring
- 21395 Plunger
- 21397 Insulating Bush
- 21401 Coupling
- 21505 Screw
- 21782 Casting for Bogie Underframe
- 22224 Mounting Plate
- 22225 Top Casting
- 22228 Bottom Casting
- 22229 Sideframe
- 22230 Armature Shaft Assembly
- 22234 Worm Wheel
- 22243 Ball Bearing Complete

ASSEMBLY

- 22214 Body Assembly
- 3212 Screw
- 11221 Self Adhesive Tape
- 14776 Connecting Wire
- 20252 Tyre
- 20690 Insulating Bush
- 20703 Wheel (with tyre groove) Insulated
- 20637 Screw
- 20690 Insulating Bush
- 20702 Wheel (Insulated)

Wheel (Insulated, with tyre) Assembly
Job No. 17930

Wheel (Insulated) Assembly
Job No. 18158

- 21054 Wire Collector
- 21785 Base for Collector
- 21786 Cover for Collector
- 22232 Weight
- 22237 Collector Insulator
- 22238 Collector Assembly
- 21394
- 21395
- 7715
- 20746
- 1183
- 21792
- 11297
- 21372
- 21793
- 7523
- 20250 (2+3 RAIL)
- 18158 (2 RAIL)
- 20250 (3 RAIL)

ASSEMBLIES

- 22226 Motor Bogie Assembly
- 22239 Rear Bogie Assembly

3 RAIL

- 1183 Soldering Tag
- 1212 Nut
- 7523 Screw
- 11297 Collector Shoe Spring
- 11299 Distance Piece
- 11553 Insulator
- 21372 Collector Shoe
- 21792 Insulator
- 21793 Collector Shoe Holder

ASSEMBLIES

- 22241 Motor Bogie Assembly
- 22242 Rear Bogie Assembly